

2024 / UIAA Ice Climbing Continental Open

Žilina

SLOVAKIA

23 NOVEMBER 2024

ORGANISED BY:



Slovak Mountaineering Union JAMES

&



LA SKALA Climbing Centre





UIAA International Climbing and Mountaineering Federation
UNION INTERNATIONALE DES ASSOCIATIONS D'ALPINISME

EVENT ORGANIZER'S PARTNERS & SPONSORS



MINISTERSTVO
CESTOVNÉHO RUCHU
A ŠPORTU
SLOVENSKEJ REPUBLIKY

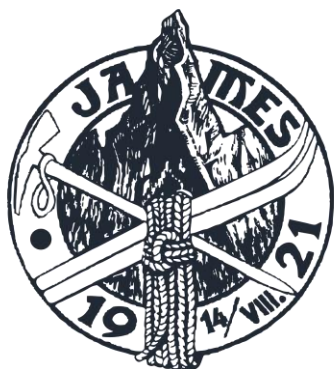

KUŽNIA
SZPEJU



DUBNÁ SKALA
Hotel



UIAA International Climbing and Mountaineering Federation
UNION INTERNATIONALE DES ASSOCIATIONS D'ALPINISME

ORGANISATION

Organizers are Host federation Slovak Mountaineering Union JAMES and its member club LA SKALA.

Host Federation:

SMU JAMES

Junácka 6

832 80 Bratislava, Slovakia

Website: www.james.sk

e-mail address: sekretar@james.sk

Organizer:

LA SKALA lezecké centrum

Centrálňa 8919/2

010 07 Žilina, Slovakia

Website: www.laskala.sk

e-mail address: info@laskala.sk

COMPETITION VENUE

Indoor Climbing Center:

LA SKALA climbing center

Centrálňa 8919/2

010 07 Žilina, Slovakia

Location: [Google Maps](#)



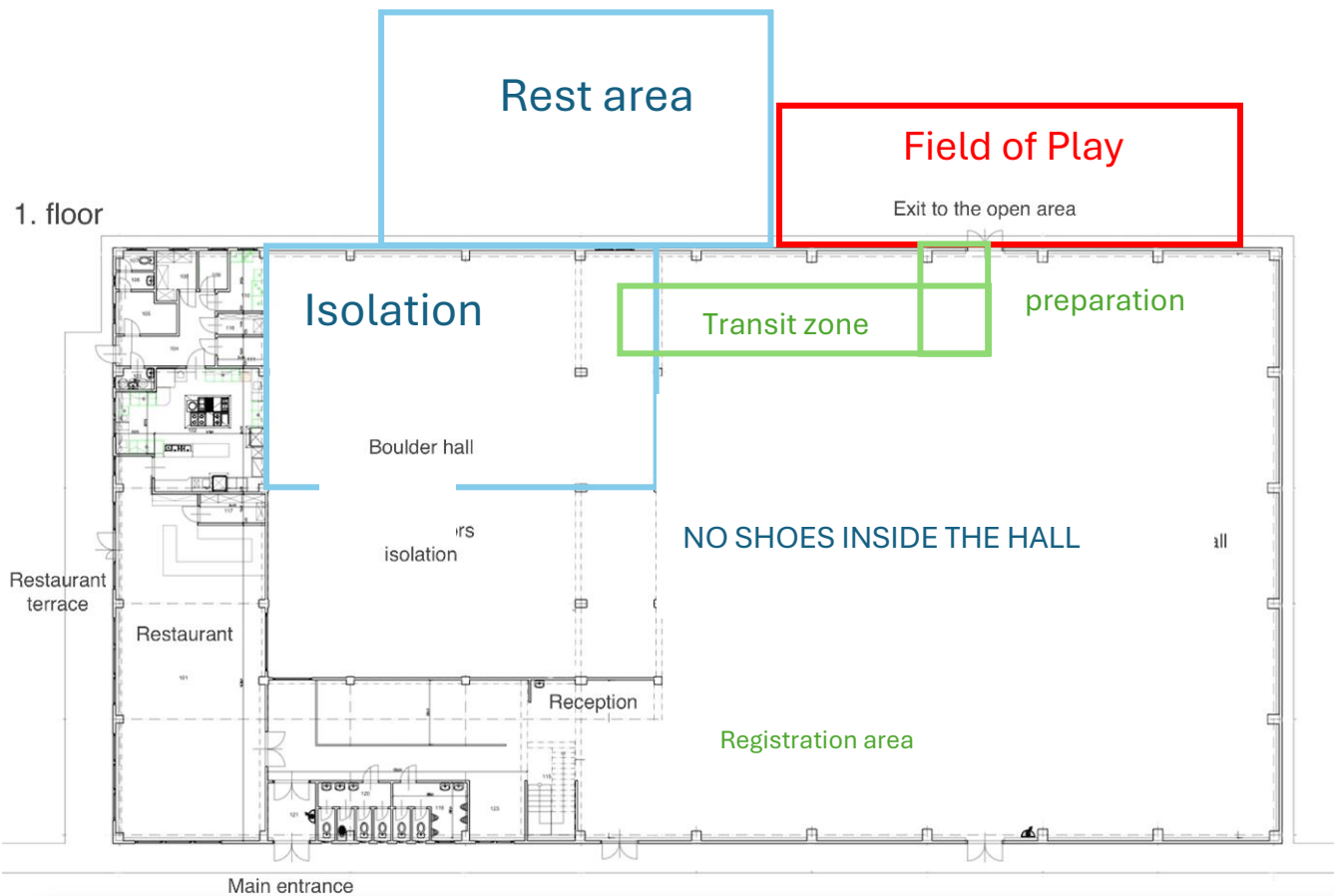

Changes to organisation of the rest area may change



UIAA International Climbing and Mountaineering Federation
UNION INTERNATIONALE DES ASSOCIATIONS D'ALPINISME

TEAM

Event director: Patrícia Rafajdusová +421 908 571 006 (Please contact through WhatsApp)

Technical delegate: Patrícia Rafajdusová

Main Judge: Oana-Maria Harabagiu (ROU)

Chief routesetter: Peter Kuric jr. (SVK)

Routesetter: Olga Kosek (POL)

STARTING FEE

Basic fee for pre-registered 50€ **CASH ONLY**

- SMU JAMES and CHS members discount 10€

FORMAT OF THE COMPETITION

Qualification:

FLASH – 2 routes per category

Finals:

OS – 1 route per category

REGISTRATION

Pre-registration

23.11. 8:00 - 9:00 Confirmation of registration at the venue

NOTICE: please, make sure you are pre-registered, [registration at the venue will not be possible](#)

ROUTE DEMONSTRATION

video demonstration via WhatsApp group

WHATSAPP GROUP FOR ATHLETES

All official info such as a technical meeting, start lists, and official results will be published here:





UIAA International Climbing and Mountaineering Federation
UNION INTERNATIONALE DES ASSOCIATIONS D'ALPINISME

TRAVEL DETAILS

VISA:

If you need VISA invitation, please contact sekretar@james.sk before 20th of November 2024. Please don't forget to attach a copy of your passport.

How to get here:

By plane

Direct plane flight to Žilina only operates locally, therefore we recommend using international airports, the closest international airports are: Bratislava (SVK), Kosice (SVK), Wien (AUT), Budapest (HUN), Prague (CZE), Krakow (POL).

By train

The main railway station in Žilina is one of the most important railway stations in Slovakia. There are direct trains from several European cities, including Bratislava (SVK), Vienna (AUT) or Prague (CZE). There is also a possibility to arrive from Budapest (HUN) and change trains in Bratislava or Vienna. You can find your train options at the national railways website: <https://www.zsr.sk/en/>

By car

Žilina is located right on the main highway D1 (E58) and is easily accessed by car. It takes about 2 hours from Bratislava, 3 hours from Vienna, 3 hours from Košice, 3 hours from Krakow, 4 hours from Budapest, 4,5 hours from Prague.



UIAA

International Climbing and Mountaineering Federation
UNION INTERNATIONALE DES ASSOCIATIONS D'ALPINISME

ACCOMMODATION

BOUTIQUE HOTEL DUBNÁ SKALA****

The hotel is located in the historic center of Žilina and provides exclusive spaces with a unique design. Hotel guests have the opportunity to use the services of the hotel's Relax Center free of charge, which include a jacuzzi, a Finnish sauna, a hydromassage shower and a stationary bicycle. In addition to the comfortable equipment of the center, you can also enjoy massages or exclusive cosmetic procedures of the Sothys Paris brand.

Accommodation offers the UIAA Ice Climbing Continental Open participants 20% discount on the price of accommodation. [When booking, use the Enter code LASKALA to guarantee this discount.](#) The use of the code is valid for accommodation from 21.11.2024 do 25.11.2024.

Accommodation offers for UIAA Ice Climbing Continental Open participants a 20% discount on:

Accommodation fee, Breakfast, Parking, Wi-Fi connection, and 20% discount on the menu in the hotel's restaurant.

Hotel Galileo:

Located within the walking distance of the venue (18 min).

Accommodation offers for UIAA Ice Climbing Continental Open participants:

One person room 48€ / 1 room / 1 night + city tax 2€ / 1 person / 1 night

Two person room 50€ / 1 room / 1 night + city tax 2€ / 1 person / 1 night

Breakfast: 7€ / 1 person / 1 day

Reservation and availability can be checked through: info@hotelgalileo.sk (Please, don't forget to MENTION that you are the participants of UIAA Ice Climbing Continental Open by [using password 'LA SKALA'](#)).

Penzión Kamélia:

Located within the walking distance of the venue (15 min.).

Accommodation offers for UIAA Ice Climbing Continental Open participants a 5% discount:

One-bed room 63,65€ / 1 night including breakfast and parking + city tax

Two-bed room 80,75 €€ / 1 night including breakfast and parking + city tax

Reservation and availability can be checked through +421 948 235 725;

rezervacie@penzionkamelia.sk (Please, don't forget to MENTION that you are the participants of UIAA Ice Climbing Continental Open by [using password 'LA SKALA'](#)).

There are also several smaller capacity Airbnb renting spots located near the event venue and several more within the town of Žilina, where many locations are reachable within a walking distance and public transport is relatively easily accessible. Booking.com also hosts several suitable locations.



UIAA International Climbing and Mountaineering Federation
UNION INTERNATIONALE DES ASSOCIATIONS D'ALPINISME

HEALTHCARE SYSTEM INFORMATION

Emergency local doctor during the event:

Emergency local doctor will be in the Venue during the entire competition.

Local healthcare system links and other useful info:

To access healthcare services, foreign athletes should obtain a European Health Insurance Card (EHIC) or equivalent documentation from their home country. This will ensure that they are covered for any necessary medical treatment during their stay. For more information on the Slovak healthcare system, please follow this link.

Emergency medical service:

Faculty Hospital Žilina (7 min. from the venue by car)

Address: Vojtecha Spanyola 43, 01207 Žilina

Phone contact: +421 51 10 348, +421 72 33 383 Website: www.fnsrza.sk

SUSTAINABILITY CONSIDERATIONS

No temporary infrastructure needs to be built to host the UIAA Ice Climbing Continental Open 2024. Only existing walls and buildings will be used to facilitate the event. In general, SHS JAMES and LA SKALA Žilina take sustainability actions very seriously and try to implement a “green way of thinking” in all areas of their everyday business and into the organization of events.

At the venue:

Recycling spots are in several places of the venue. We will be pleased if participants and teams join the sustainability cause by bringing their own bottles and other equipment that can help reduce waste produced at the venue. The venue is wheel-chair accessible.

Food:

There is a restaurant right at the venue (RESTAURANT SKALA), which also provides vegetarian options for food. There are several other restaurants (Pizzeria Mánia, etc.) and grocery shops around. The Kraj grocery store, less than a 5- minute walk away from the venue, also offers a variety of local and regional Slovak foods. Food trucks will be at the outside area next to field of play [including vegetarian and vegan food](#).

Transport:

Public transport in Žilina

The event venue LA SKALA is accessible from bus stop [Rudnayova \(trolleybus 3\)](#) and [Pod hájom \(buses 50 and 67, trolleybuses 1, 7, 14\)](#), you can look up your connection through [THIS LINK](#). Tickets can be bought in paper or paper or short message service (SMS) form that you can find on bus stops or in buses.

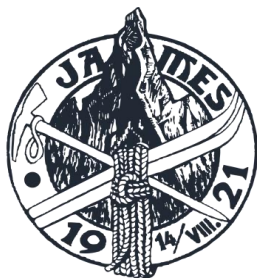

PROVISIONAL PROGRAMME (LOCAL TIME)

Friday 22nd November	ONLINE TECHNICAL MEETING	
	5:00 PM – 7:00 PM	Technical meeting and videos will be sent via WhatsApp group
Saturday 23rd November	Qualification	
	8:00	Climbing gym opens
	8:00-9:00	Registration
	9:30-9:40	Technical meeting
	10:00-16:00	Qualification
Saturday 23rd November	Finals	
	16:40	Isolation opens for Finals
	17:00	Isolation closes for Finals
	17:50	Presentation of Finalists and Observation
	18:00	Finals for both categories
	19:30	Awards ceremony

STREAMING & TV BROADCASTING

Streaming for all rounds:

Live streaming for all rounds in one place: <https://app.riverstream.sk/shsjames/sign/in>

Streaming of the event on UIAA YouTube Channel:

Live television broadcasting on JOJ Šport: